

Maximum 1760 kW (2360 hp) @1800 RPM (CONTINUOUS DUTY)

**STANDARD EQUIPMENT****MGX-5600DR**

Vertical offset, cast iron housing

Input hub for freestanding installation

Electric GP-valve with manual override

EC050 Profile module

- interface for engagement signals

Mounted oil cooler for raw

- or fresh water cooling

Oil strainer and oil filter

Companion flange/bolt set

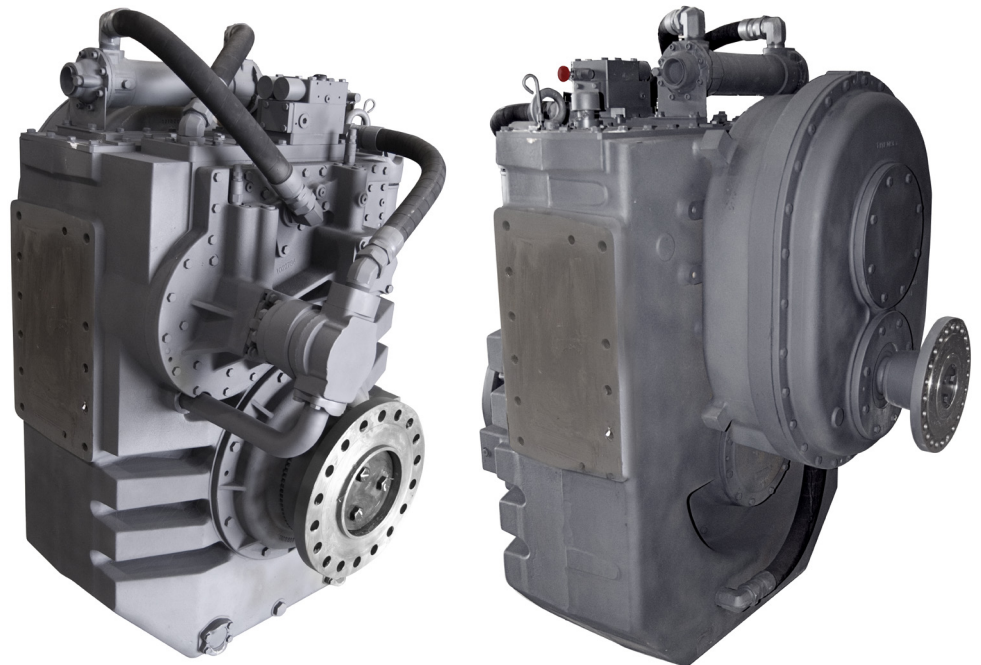

**QUICKSHIFT®**  
You've got to feel it to believe it.

**INPUT RATINGS - KILOWATTS (KW) (HORSEPOWER (HP))\***For service classification definitions and important notes refer to [www.twindisc.com](http://www.twindisc.com), the Twin Disc Marine Product Guide or contact Twin Disc directly.

Reduction Ratios :1	Continuous Duty		
	@ 1200 RPM	@ 1600 RPM	@ 1800 RPM
4.20, 6.02	1151 kW (1543 hp)	1564 kW (2097 hp)	1760 kW (2360 hp)
6.56	1038 kW (1392 hp)	1458 kW (1955 hp)	1641 kW (2201 hp)
7.01	964 kW (1293 hp)	1352 kW (1813 hp)	1566 kW (2100 hp)
7.22	845 kW (1133 hp)	1088 kW (1459 hp)	1207 kW (1619 hp)

\* Ratings shown for use with standard right-hand rotation engines.  
The maximum allowable rated engine speed is 2100 rpm.



Specifications subject to change without prior notice in the interest of continual product improvement.  
Contact your local Twin Disc representative for engineering specifications, Survey Society Approvals  
and Classifications.

Scan QR code to see Twin Disc's entire Marine product line.



## OPTIONS

- Hydraulically operated internal shaft brake
- Mechanical control valve
- EC050 E-Troll module – interface for engagement & trolling signals
- Harness with single point interface to Twin Disc EC300 control system
- Output shaft driven trailing pump
- Special companion flange/bolts set for shaft brake application
- Monitoring devices to customer's specification
- Mounting brackets
- Live PTO

SAE J744 size 127-2/4, 32-4 (SAE "C", 2/4-bolt) – max. 592 Nm

SAE J744 size 127-2/4, 38-4 (SAE "C-C", 2/4-bolt) – max. 1187 Nm

### Hydraulic Clutchable pump mount PTO

SAE J744 size 127-2/4, 32-4 (SAE "C", 2/4-bolt) – max. 600 Nm

SAE J744 size 127-2/4, 38-4 (SAE "C-C", 2/4-bolt) – max. 1186 Nm

Dry weight incl. input flange: **3465 kg**

For nearly a century, we've been making boats perform better and more reliably. From system-design consultation to application development to in-service support, Twin Disc provides fully integrated propulsion solutions that will optimize your craft's performance, reliability and safety over the years. Bring Twin Disc aboard early in the development process, and you'll enjoy a lifetime of enhanced operating value.

TRANSMISSIONS • ELECTRONIC CONTROLS • EXPRESS JOYSTICK SYSTEM® • SAILDRIVES • EXPRESS POSITIONING® • ARNESON SURFACE DRIVES • MARINE CONTROL DRIVES • ROLLA PROPELLERS • BOW & STERN THRUSTERS • STEERING SYSTEMS • RUDDERS • TRIM TABS

## MGX-5600DR

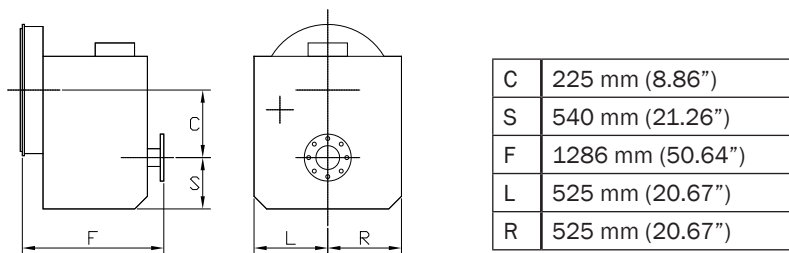

Twin Disc, Incorporated reminds users of these products that their safe operation depends on use in compliance with engineering information provided in our catalog. Users are also reminded that safe operation depends on proper installation, operation and routine maintenance and inspection under prevailing conditions. It is the responsibility of users (and not Twin Disc, Incorporated) to provide and install guards or safety devices which may be required by recognized safety standards or by the Occupational Safety and Health Act of 1970 and its subsequent provisions.

United States of America • Australia • Belgium • Canada • China • India • Italy • Singapore • Switzerland



Twin Disc, Incorporated  
Racine, Wisconsin 53403 USA  
Phone +1-262-638-4000  
Fax +1-262-638-4482  
[www.twindisc.com](http://www.twindisc.com)

*TD-Bulletin-MGX-5600DR*  
© 2016, Twin Disc, Incorporated  
Printed in the USA - 2/2016