

Maximum 716 kW (960 hp) @1800 RPM (CONTINUOUS DUTY)

STANDARD EQUIPMENT

MGX-5321DC

- Vertical offset, nodular iron housing
- Electric GP-valve with manual override
- EC050 Profile module
 - interface for engagement signals
- Mounted oil cooler for raw water cooling
- Oil strainer and oil filter

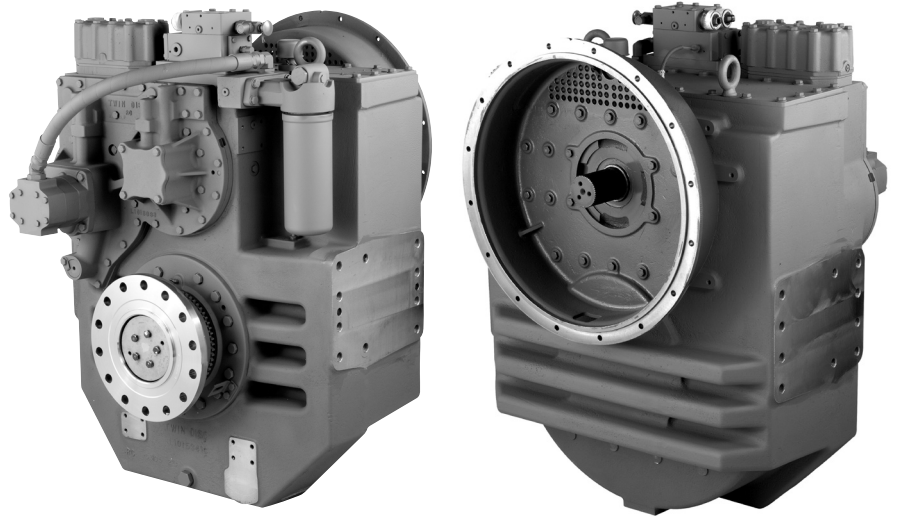

INPUT RATINGS - KILOWATS (KW) (HORSEPOWER (HP))*

For service classification definitions and important notes refer to www.twindisc.com, the Twin Disc Marine Product Guide or contact Twin Disc directly.

Reduction Ratios :1	Intermediate Duty		Medium Duty		Continuous Duty	
	@ 1800 RPM	@ 2100 RPM	@ 1600 RPM	@ 1800 RPM	@ 1600 RPM	@ 1800 RPM
3.35, 4.06, 4.42 4.96, 5.46	1044 kW (1400 hp)	1163 kW (1560 hp)	928 kW (1244 hp)	1044 kW (1400 hp)	882 kW (1183 hp)	982 kW (1317 hp)
5.96			865 kW (1160 hp)	969 kW (1300 hp)	861 kW (1155 hp)	969 kW (1300 hp)
6.39	893 kW (1198 hp)	1022 kW (1371 hp)	776 kW (1041 hp)	863 kW (1157 hp)	737 kW (988 hp)	812 kW (1089 hp)

* Ratings shown for use with standard right-hand rotation engines.
The maximum allowable rated engine speed is 2400 rpm.



Specifications subject to change without prior notice in the interest of continual product improvement. Contact your local Twin Disc representative for engineering specifications, Survey Society Approvals and Classifications.

Scan QR code to see Twin Disc's entire Marine product line.



OPTIONS

- SAE J617 housing no.0
- SAE J617 housing no.00
- Flexible coupling for 18" flywheel (SAE J620 size 460)
- Flexible coupling for 21" flywheel (SAE J620 size 530)
- Input hub for freestanding installation
- Mechanical control valve
- EC050 E-Troll module – interface for engagement & trolling signals
- Harness with single point interface to Twin Disc EC300 control system
- Oil cooler for fresh water cooling
- Output shaft driven trailing pump
- Companion flange/ bolts set
- Special companion flange/bolts set for shaft brake application
- Monitoring devices to customer's specification
- Mounting brackets
- Live PTO
 - SAE J744 size 127-2/4, 32-4 (SAE "C", 2/4-bolt) – max. 592 Nm
 - SAE J744 size 127-2/4, 38-4 (SAE "C-C", 2/4-bolt) – max. 1187 Nm
- Hydraulic clutchable pump mount PTO
 - SAE J744 size 127-2/4, 32-4 (SAE "C", 2/4-bolt) – max. 592 Nm
 - SAE J744 size 127-2/4, 38-4 (SAE "C-C", 2/4-bolt) – max. 1186 Nm
- Dry weight incl. SAE #0 housing and SAE 460 flexible coupling: **1754 kg**

MGX-5321DC

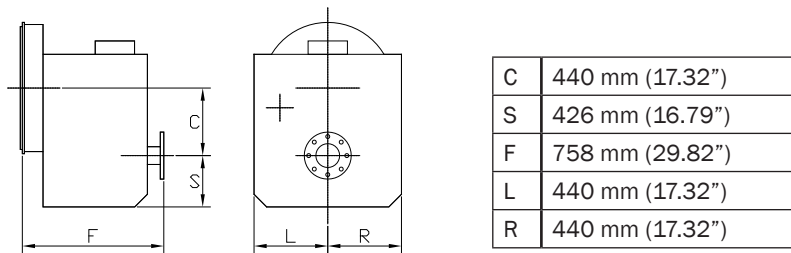

Twin Disc, Incorporated reminds users of these products that their safe operation depends on use in compliance with engineering information provided in our catalog. Users are also reminded that safe operation depends on proper installation, operation and routine maintenance and inspection under prevailing conditions. It is the responsibility of users (and not Twin Disc, Incorporated) to provide and install guards or safety devices which may be required by recognized safety standards or by the Occupational Safety and Health Act of 1970 and its subsequent provisions.

United States of America • Australia • Belgium • Canada • China • India • Italy • Singapore • Switzerland

For nearly a century, we've been making boats perform better and more reliably. From system-design consultation to application development to in-service support, Twin Disc provides fully integrated propulsion solutions that will optimize your craft's performance, reliability and safety over the years. Bring Twin Disc aboard early in the development process, and you'll enjoy a lifetime of enhanced operating value.

TRANSMISSIONS • ELECTRONIC CONTROLS • EXPRESS JOYSTICK SYSTEM® • SAILDRIVES • EXPRESS POSITIONING® • ARNISON SURFACE DRIVES • MARINE CONTROL DRIVES • ROLLA PROPELLERS • BOW & STERN THRUSTERS • STEERING SYSTEMS • RUDDERS • TRIM TABS



Twin Disc, Incorporated
Racine, Wisconsin 53403 USA
Phone +1-262-638-4000
Fax +1-262-638-4482
www.twindisc.com

TD-Bulletin-MGX-5321DC
© 2016, Twin Disc, Incorporated
Printed in the USA - 2/2016