

spicer 1550 input flange
IT2062313

central input rotation

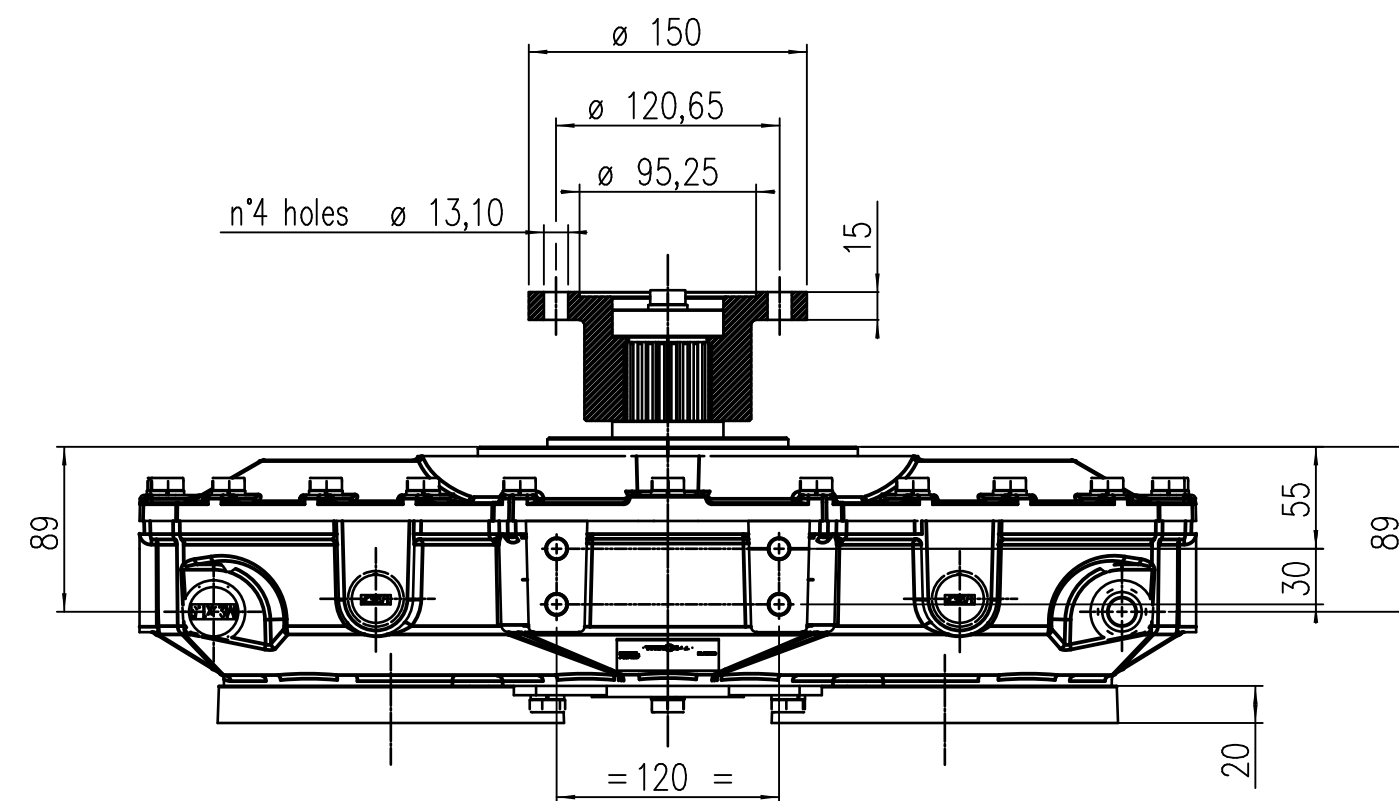
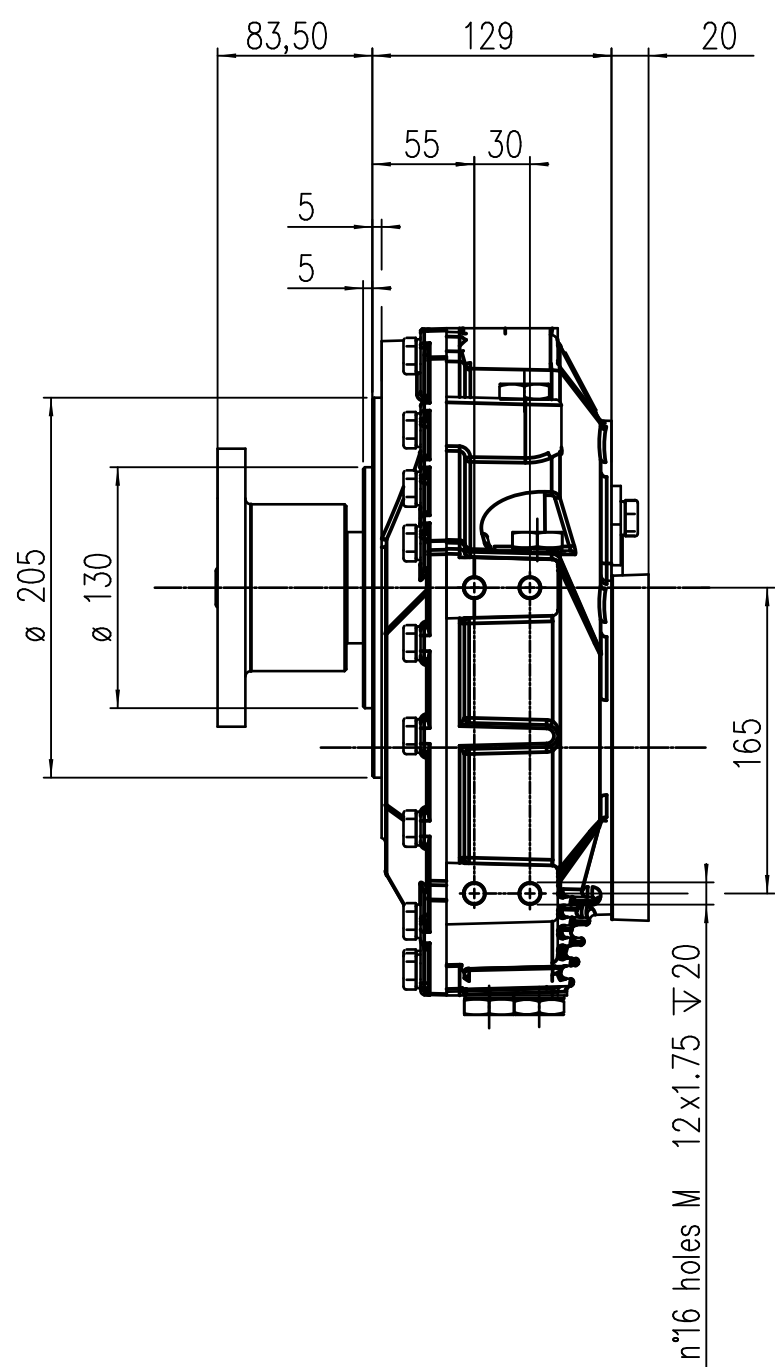
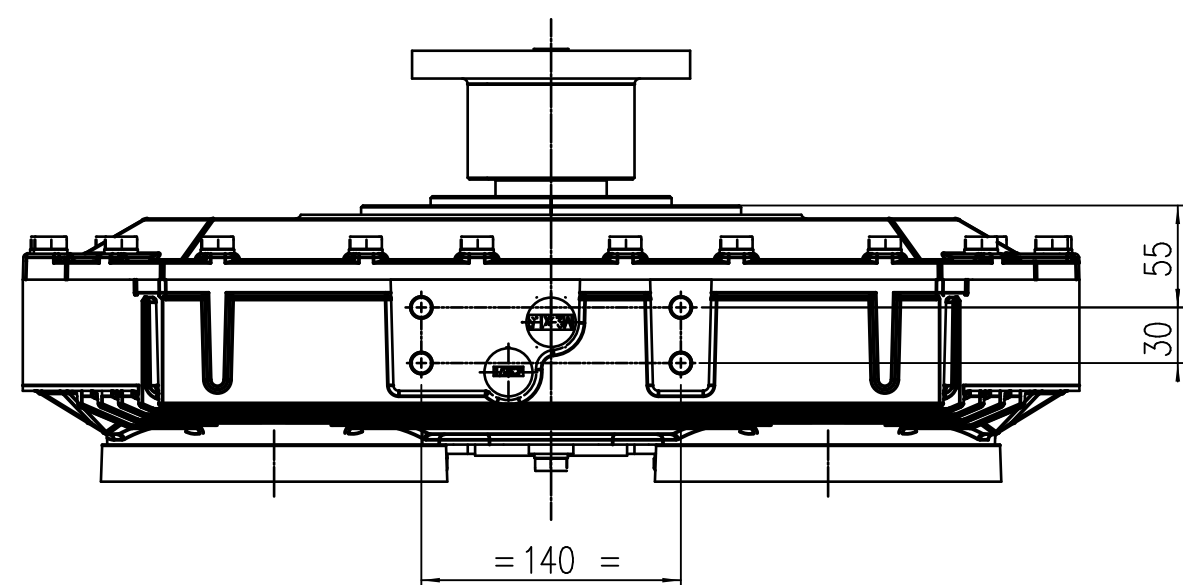
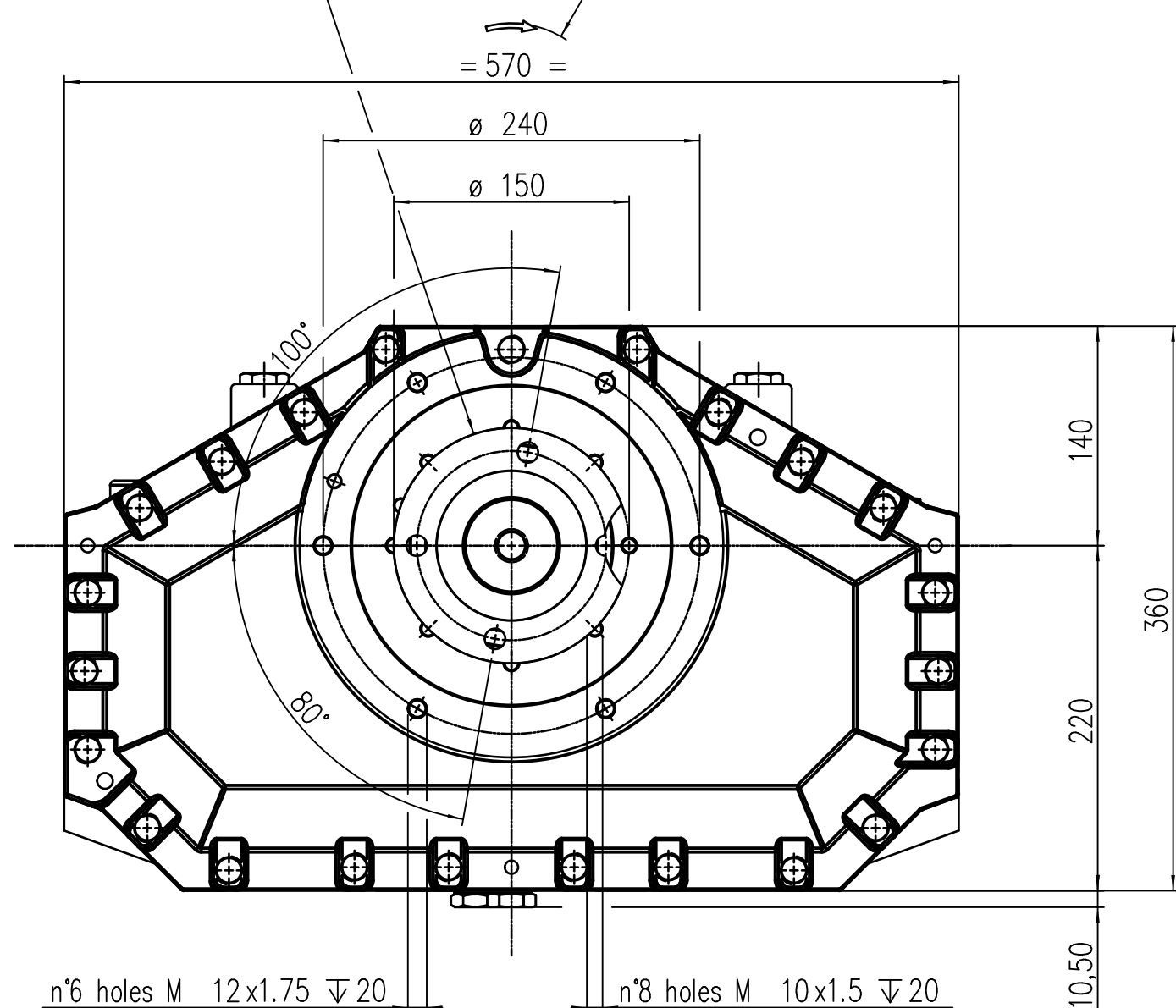

pump pad IT1041103

pump pad IT1041103

Oil dipstick
Breather plug

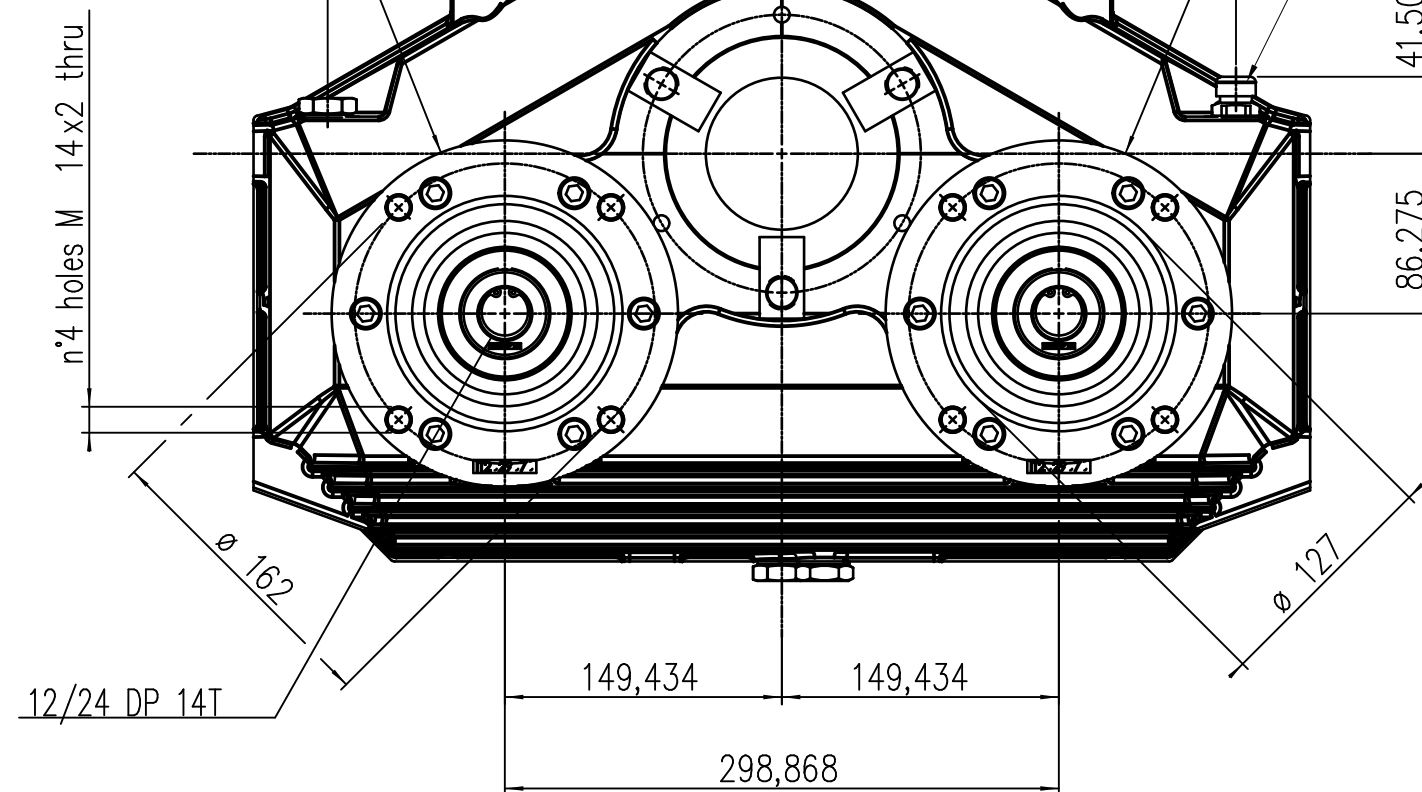

Drawing and 3D model are valid for all ratios

| | | | | | |
|--|--|-------------------|--|---|---|
| FIRST USE ASSEMBLY: | | WEIGHT: | THIRD ANGLE PROJECTION | MATERIAL: | DATE: |
| FIRST USE MODEL: | | kg | | HEAT TREAT: | 20-Nov-14 |
| SIMILAR TO: | | kg-m ³ | UNLESS OTHERWISE SPECIFIED MACHINED DIMENSIONS F ±0,75 H ±0,25 T ±0,13 | DESCRIPTION: | SCALE: |
| METRIC <small>NOTE: THIS PRINT CONTAINS PROPRIETARY INFORMATION AND IS NOT TO BE USED IN ANY MANNER DEEMED TO BE IN THE INTEREST OF TWIN DISC, INCORPORATED. THIS WORK IS NOT INTENDED TO ALIENATE OR LIMIT RIGHTS GRANTED TO THE U.S. GOVERNMENT OR OTHERS BY CONTRACT.</small> | | | ALL ANGULAR TOLERANCES ± 1 GEOMETRIC TOLERANCING PER ASME Y14.5M 1994 | Installation pump drive, AM 220 BOM n°1029014B | 1:4 |
| | | | | APPROVED BY: | TWIN DISC S.p.A. - ITALY 1029015A |
| | | | | CHECKED BY: | DWG SIZE: A2 SHEET: 1 OF 1 REV: - |
| | | | | APPROVED BY: | format: A2-TAP-IT rev- |